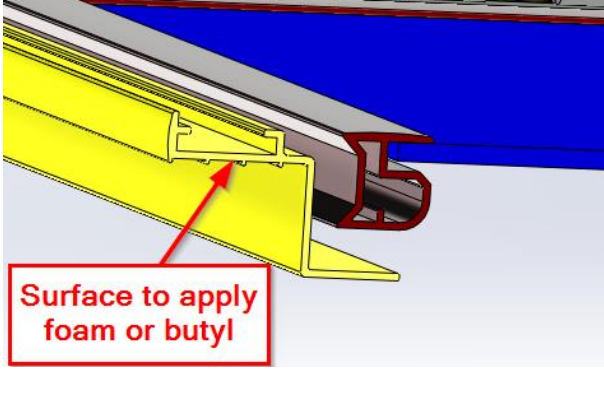

Challenger Door

200/250/300 Series Installation Guide Date: 12/12/18

BY:AWY

****Be sure to check that Rough Opening measures to the size stated on the door label, and is square and even on all sides. Challenger Door sizes doors to properly fit whatever opening our customer has. Be sure that the opening has proper framework supporting it (ie; aluminum/steel tubing or lumber). For any clarification on how to measure Rough Opening visit <https://www.challengerdoor.com/measure/> ****

Tools and Supplies needed	<ul style="list-style-type: none">- screw gun- #8 or #10 screws 1" to 1½" long (Self-drilling screws are recommended)- closed cell foam tape or butyl tape- water sealing caulk and caulk gun- plastic or wood shims 1/8" to 3/16" thick.	
Place door in opening	<ol style="list-style-type: none">1. Clean out and install closed cell foam or butyl. This helps to insure a tight seal once door is installed.2. Center door in opening it insure proper fit.	

Secure door into opening

1. Start on the hinge side by adding 2 screws in closest to each corner of the outer.
2. Add 2 screws on each side adjacent to the hinge side staying close to the corners.
3. Close door to check squareness and reveal (gap) between door and mounting frame.
4. Loosen screws and adjust to achieve a consistent reveal and re-tighten screws.
5. Shim where needed to keep consistent reveal. Install remaining screws filling all holes (if no pre-punched holes be sure screws are no more than 12" apart).
6. Check that the key and thumb turns move freely and engage on the lip of the mounting frame properly.

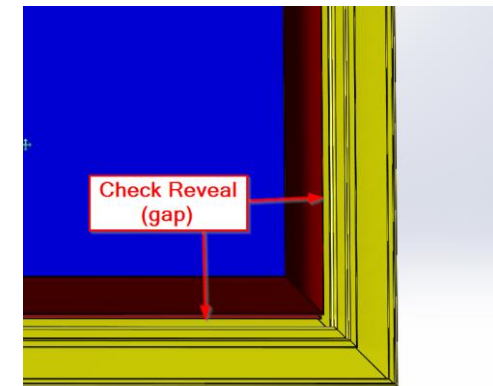
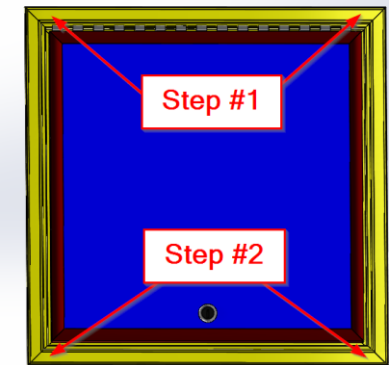

Sealing the Door

1. To ensure proper bond. Clean the mounting frame and surface it bonds to.
2. Caulk around the mounting frame to the unit sidewall.

