

Challenger Door

Process Control Document

Date :7/20/12

Process Title: Sheet :Electric lock retrofit for 1520 series

BY: Mike S.

Fig.1

Remove both linkage rods from latch as shown in figure 1 and 2.

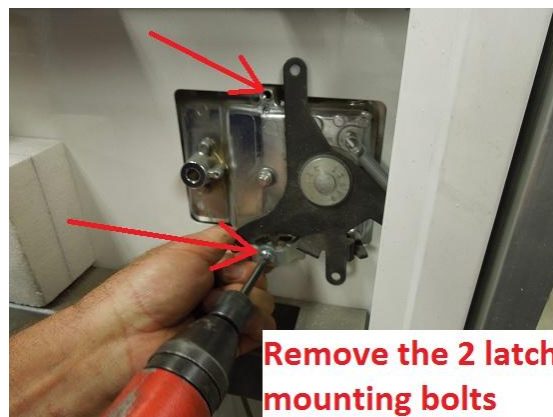

Fig.2



Fig.3

Remove the 2 mounting bolts.



Remove latch.

Fig.4.



Cut out c-channel as shown in fig.5.

Fig.5.



Reinstall latch.

Fig.6.



Fig.7.

Fasten latch using supplied longer bolts (shown in Fig.8.).



Fig.8.

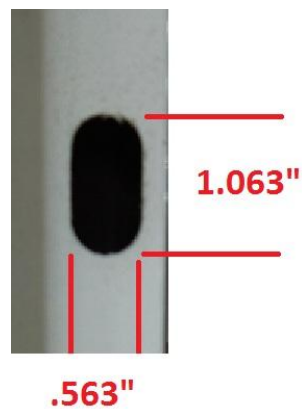

Fig.9.

Attach actuator linkage rod to the latch in location shown in Fig.9.Reattach other 2 latch linkage rods as well.



Fig.10.



Cut hole in inner and outer frame per dimensions

Fig.11.

Cut hole (size shown in Fig.10) at dimensions shown; in inner frame (Fig.11 and Fig.12) and in outer frame (Fig.13 and Fig.14.).



Fig.12.



Fig.13.

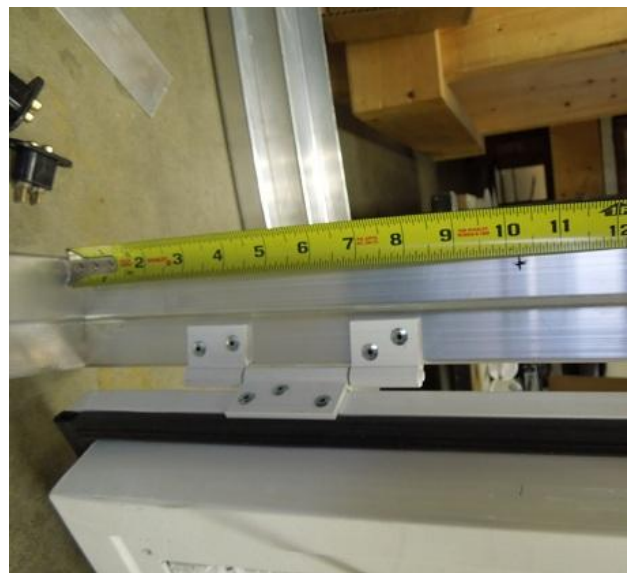

Fig.14.



Fig.15.

Run wires down from actuator to contact switch and attach to contact switch. Install contact switch to door and frame. Be sure the brass plungers on the door and the frame portion of the switch line up when installing.

